

Motors

05



**Shaded Pole
Motor Ø 52**

206

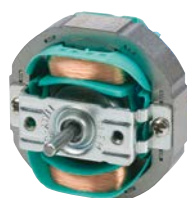

**Shaded Pole
Motor Ø 58**

208



**Fans
and Accessories**

210



EC Brushless Motor

212



SHADED POLE MOTOR Ø 52

FEATURES

Motor life: from 3.000 hours (sinterized sleeve bearings) to 30.000 hours (ball bearings)

Heat and fire resistance version available
GWIT 775 °C

2-speed version available

Class of insulation according to IEC 60085: F or H

Power supply:
from 12 VAC to 240 VAC / 1 / 50-60 Hz

Ideal for reduced space, they are available in a wide range of versions and they are featuring high electromagnetic efficiency. This allows Giem to meet several application requirements: ventilators, fan heaters, air cleaners, and humidifiers

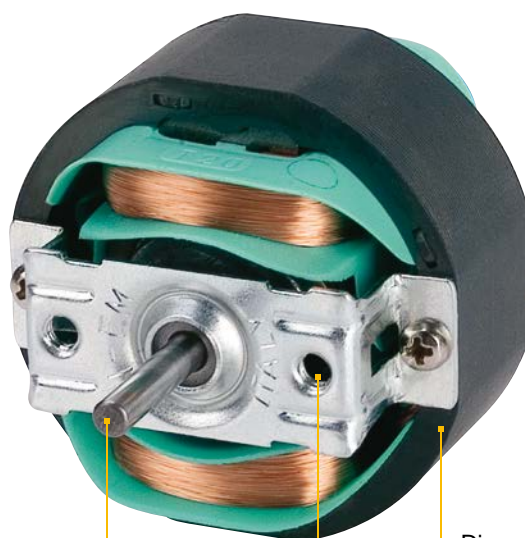

Diameter: 52 mm

Shaft diameter 4 mm;
clock-wise and counter clock-wise

Fixing holes threaded M4

OPTIONS

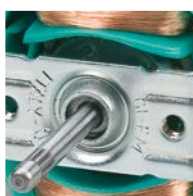

Shaft can be
smooth, milled
or with grooves
with length
on demand



Brass bearings
or ball bearings



Stack height from
16 to 30 mm

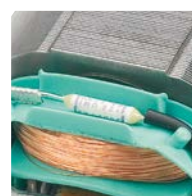

Fuse

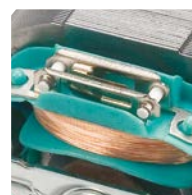

Thermostat

Motors protected by motor impedance
or thermal protected by fuse or thermo-
stat (autoreset or self holding)

DIMENSIONS

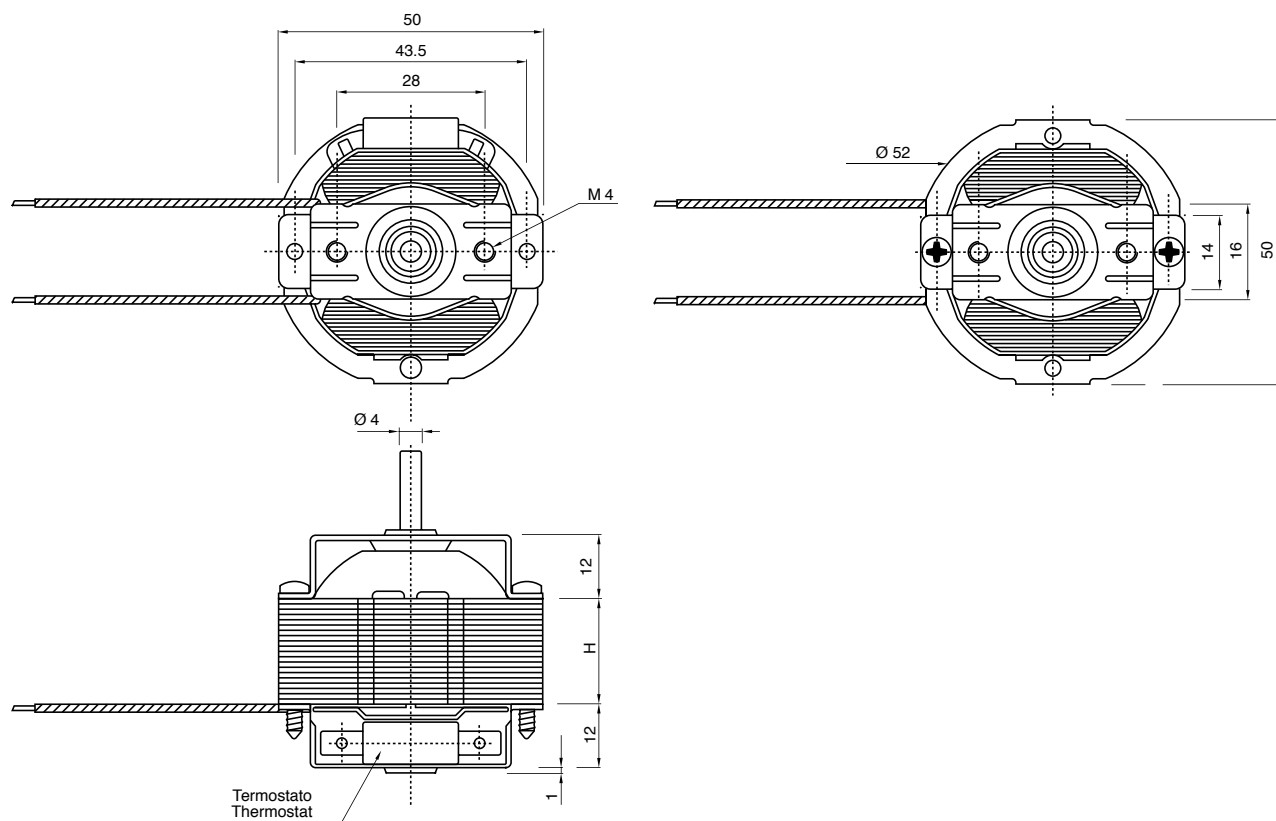

CUT OUT

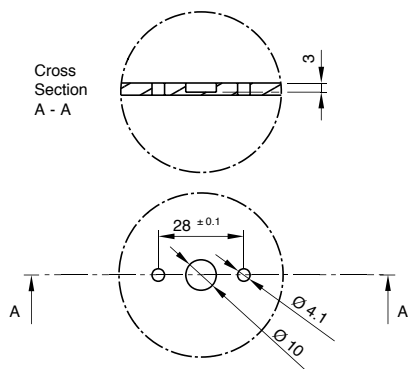

TECHNICAL FEATURES

Stack height (H) mm	Power absorption W		
	Low consumption version	Normal version	Powered version
16	8	15	25
20	10	20	25
25	15	20	30
30	20	30	40

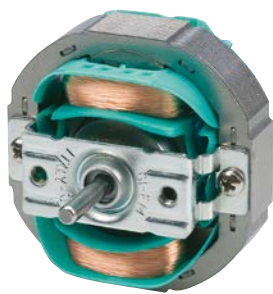

on demand

SHADED POLE MOTOR Ø 58

FEATURES

Motor life: from 3.000 hours (sinterized sleeve bearings) to 30.000 hours (ball bearings)

Heat and fire resistance version available
GWIT 775 °C

2-speed version available

Class of insulation according to IEC 60085: F or H

Power supply:
from 12 VAC to 240 VAC / 1 / 50-60 Hz

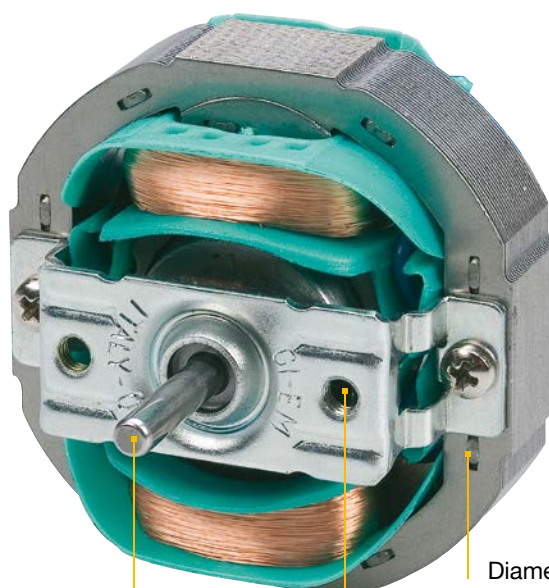

Diameter: 58 mm

Shaft diameter 4 mm;
clock-wise and counter clock-wise

Fixing holes threaded M4

OPTIONS

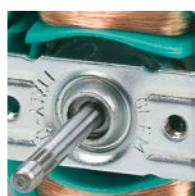

Shaft can be
smooth, milled
or with grooves
with length
on demand



Brass bearings
or ball bearings



Stack height from
12 to 35 mm

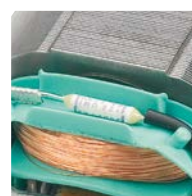

Fuse

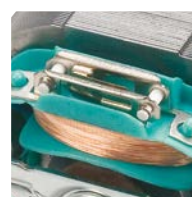

Thermostat

Motors protected by motor impedance
or thermal protected by fuse or
thermostat (autoreset or self holding)

DIMENSIONS

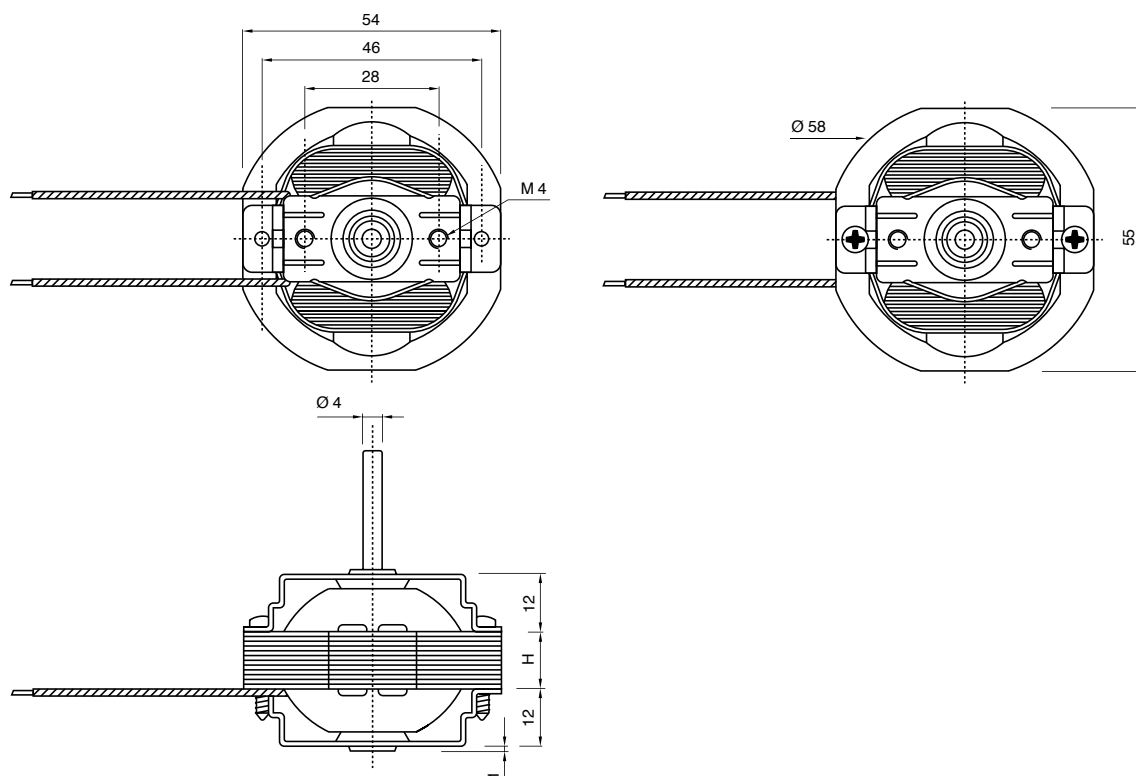

CUT OUT

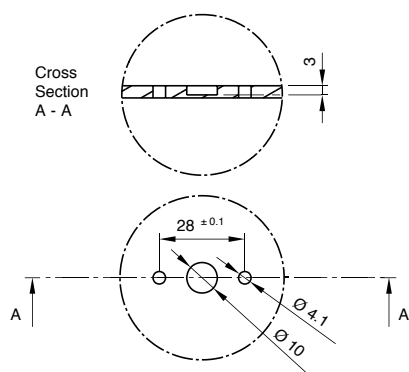

TECHNICAL FEATURES

Stack height (H) mm	Power absorption W		
	Low consumption version	Normal version	Powered version
12	8	15	25
16	10	20	30
20	15	25	30
25	15	25	35
30	20	30	40
35	20	35	50

FANS AND ACCESSORIES

AVAILABLE FOR SHADED POLE MOTORS Ø 52 AND Ø 58

FEATURES

Wide offer of fans, with different colours, materials and dimensions for motors Ø 58 and Ø 52

Forcing and suction version

Nylon or aluminum

Snap-in mounting without tools on Ø 4 mm shaft



PLASTIC 7-BLADES FAN

Material: Nylon
Colour: Black
Diameter: 130 mm

Code

GM1VN01A00

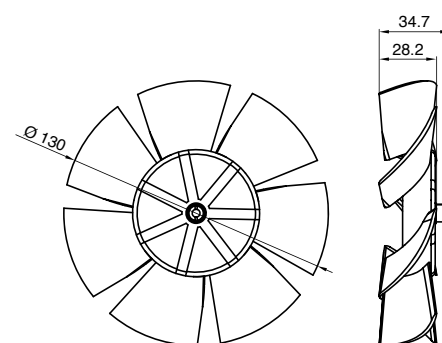

METAL 5-BLADES FAN

Material: Aluminum
Colour: Glossy
Diameter: 130 mm

Code

GMVKW52002

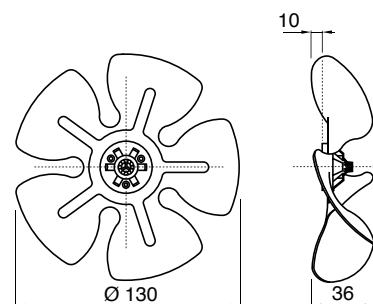



METAL 3-BLADES FAN

Material: Iron sheet
Colour: Black
Diameter: 156 mm

Code

GMVTR51004

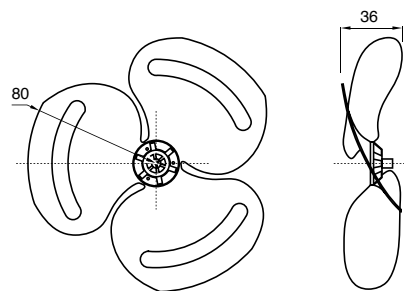

METAL 2-BLADES FAN

Material: Plastic, aluminum
Colour: Black
Diameter: 158 mm

Code

GMVCD51001

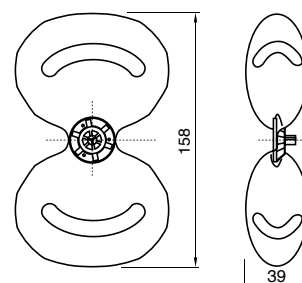

CENTRIFUGAL PLASTIC FAN

Material: Nylon
Colour: Black
Diameter: 84 mm
Height: 46 mm / 67 mm

Code (h. 46)

GMVDD00010

Code (h. 67)

GMVXX03020

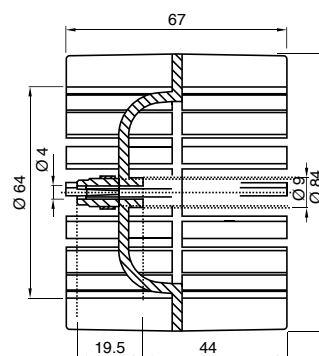
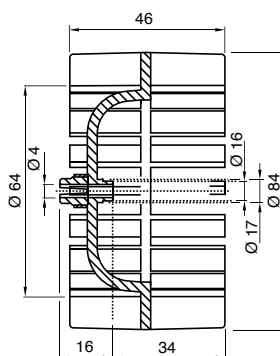
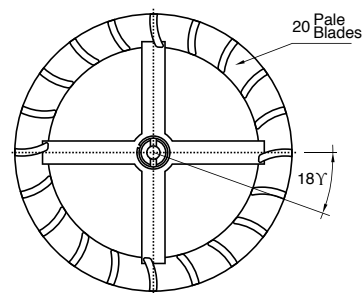

EC BRUSHLESS MOTOR



**EXTREMELY SILENT
LOW ENERGY CONSUMPTION
HIGH PERFORMANCE**

Example for Performance EC motor stack height 12 mm.

RATED VOLTAGE	230 VAC (-15%; +10%)
INSULATION CLASS	F
RATED MECHANICAL POWER	1,2 W
RATED ELECTRIC POWER	6,7 W
MOTOR EFFICIENCY	18%
WITHSTAND VOLTAGE	1800 V
TORQUE DIRECTION	CW
NUMBER OF POLES	2
DRIVE	Half bridge
MAX SPEED	3.000 rpm
PROTECTION	Thermostat 100 °C
OPERATING TEMPERATURE	-5 °C / +40 °C
NOTE	Shaft lenght: on request Wires color: on request

Everel has released the Performance and Performance Plus EC brushless motors series. The Performance Plus version, which integrates more advanced electronics, allows the control of motor speed and the possibility of reversing the rotation; humidity sensor, presence sensor, and timer can be integrated in the same board; motor efficiency up to 40%.

- Energy saving: up to 70% compared to traditional motor
- Integrated electronic
- Power supply from 12 VAC to 240 VAC / 1 / 50-60. Also available 12 VDC
- Same dimensions and cut-out of standard motors (diameter 58 mm)
- Performance Plus version: humidity sensor, presence sensor, timer, lighting mgmt, firmware customization
- Ball bearings



OPTIONALS



Shaft can be smooth, milled or with grooves with length on demand



Stack height from 12 to 35 mm

Fuse

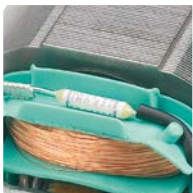

Motors protected by thermal fuse or thermostat (autoreset or self holding)

Thermostat



DRAWING

(Performance version)

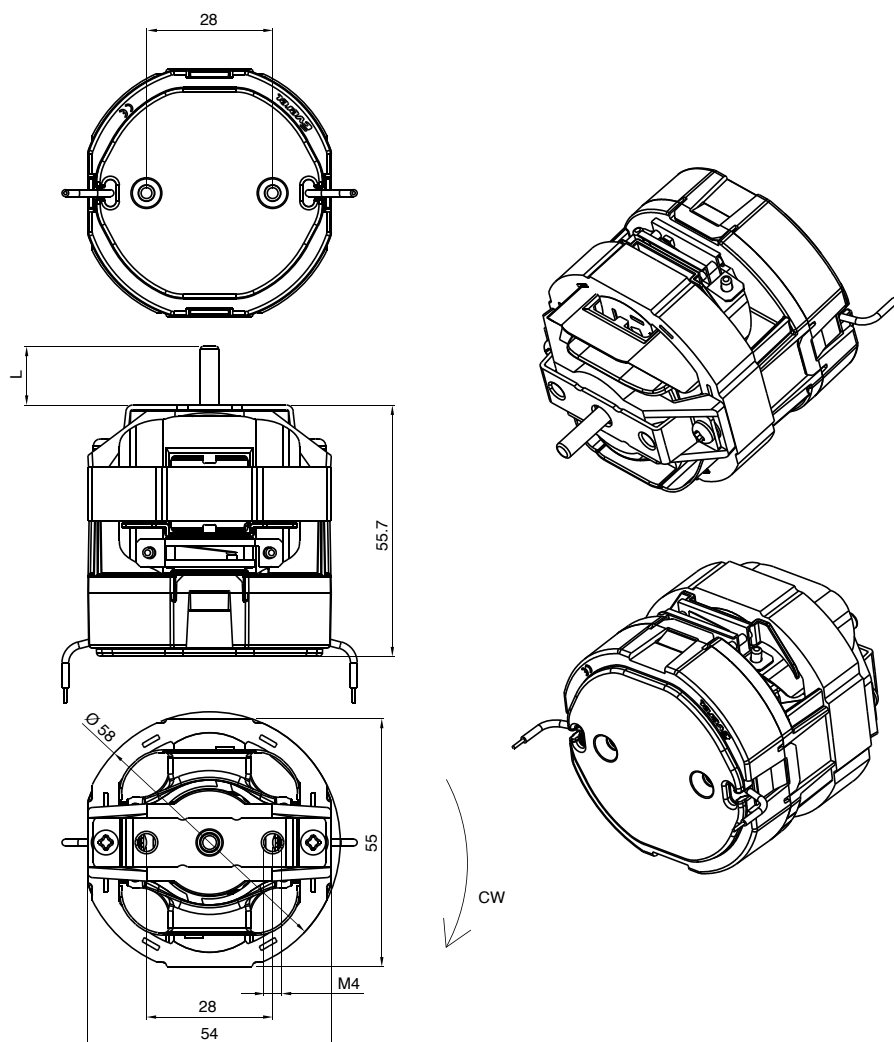

Different covers available

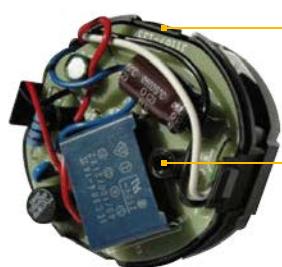
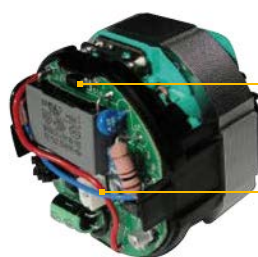
TECHNICAL FEATURES**PERFORMANCE**Integrated electronic
and power supply boardInstallation from
electronic side available**PERFORMANCE PLUS**

Timer management

Humidity sensor connector
Speed control
Presence sensor connection**SELV version 12 V available**

SELV: Safety Extra Low Voltage

Stack height (H) mm	Power absorption W	Shaft Power W
12	4,5 ... 15	0,8 ... 2,7
16	6,5 ... 20	1,2 ... 3,6
20	7,5 ... 25	1,4 ... 4,5
25	8,5 ... 30	1,6 ... 5,4
30	9,5 ... 40	1,7 ... 7,2
35	10,5 ... 50	1,9 ... 9

Stack height (H) mm	Power absorption W	Shaft Power W Plus
12	4 ... 15	1,4 ... 5,3
16	5 ... 20	1,8 ... 7
20	6 ... 25	2,1 ... 8,8
25	7 ... 30	2,5 ... 10,5
30	8 ... 40	2,8 ... 14
35	9 ... 50	3,2 ... 17,5